

IDI Precision Machinery Ltd.  
Integrity, Discipline, Innovation

# IDI Diamond Coated Tools

## Features:

IDI is a professional tool manufacturer for dental machining. We provide a complete range of endmills including premium diamond coating for zirconia and ultra hard TiALN coating for titanium and chrome cobalt parts milling. The performance of IDI tools have been proved by our customers all over the world. Today, more than one million people's zirconia crowns were made by IDI diamond tools. We are committed to offering high quality products at competitive prices. Your satisfaction is our goal.

## Features:

IDI ist ein professioneller CNC-Fräser Hersteller für den dentalen Markt. Wir bieten die komplette Auswahl an Fräsern, inklusive Diamantbeschichtungen für Zirkon, und extra harte TiALN-Beschichtungen für Titan und Chrom-Kobalt Bearbeitung. Die Leistungsfähigkeit und Qualität unserer Fräser hat sich schon bei unseren Kunden auf der ganzen Welt bewährt. Bis heute wurden bereits mehr als eine Million Zirkoneinheiten mit IDI-Fräsern gefertigt. Wir bieten hoch qualitative Produkte zu einem attraktiven Preis. Unser Ziel ist Ihre Zufriedenheit.

[www.iditools.com](http://www.iditools.com)

## Tool Features:

1. special substrates for zirconia, titanium and chrome cobalt cutting
2. sharp cutting geometry for high performance machining
3. state-of-the-art diamond coating and ultra hard TiALN coatings
4. extensive experience and total solution in dental field

## Eigenschaften:

1. Spezielle Beschichtungen für Zirkon-, Titan- und Chrom Kobalt Fräsarbeiten
2. Sehr scharfe Geometrien für eine schnelle Bearbeitung
3. Modernste Diamant-, und extrem harte TiALN- Beschichtungen
4. Langjährige Erfahrung und Komplettlösungen im Dentalbereich



## Tools for Titanium, and Cobalt-Chrome alloy (Metric) Fräser für Titanum, und Kobalt-Chrom-Legierungen ( Metrisch )

unit: mm

Tool Type	Part No.	Cutting Diameter A	No. of Flutes	Flute Length B	Effective Length C	Overall Length D	Shank Diameter E	Corner Radius F
Square End Quadratisch	TMS05-2-1-1-42	0.5	2	1	1	42	4	
	TMS05-2-1-4-42	0.5	2	1	4	42	4	
	TMS1-2-2-6-42	1	2	2	6	42	4	
	TMS1-2-2-10-42	1	2	2	10	42	4	
	TMS1.5-2-3-10-42	1.5	2	3	10	42	4	
	TMS1.5-2-3-14-42	1.5	2	3	14	42	4	
	TMS2-2-4-10-42	2	2	4	10	42	4	
Ball Nose Kugelförmig	TMS2-2-4-14-42	2	2	4	14	42	4	
	TMB05-2-1-1-42	0.5	2	1	1	42	4	
	TMB05-2-1-4-42	0.5	2	1	4	42	4	
	TMB1-2-2-6-42	1	2	2	6	42	4	
	TMB1-2-2-10-42	1	2	2	10	42	4	
	TMB1.5-2-3-10-42	1.5	2	3	10	42	4	
	TMB1.5-2-3-14-42	1.5	2	3	14	42	4	
Corner Radius flach	TMB2-2-4-10-42	2	2	4	10	42	4	0.2
	TMB2-2-4-14-42	2	2	4	14	42	4	0.2

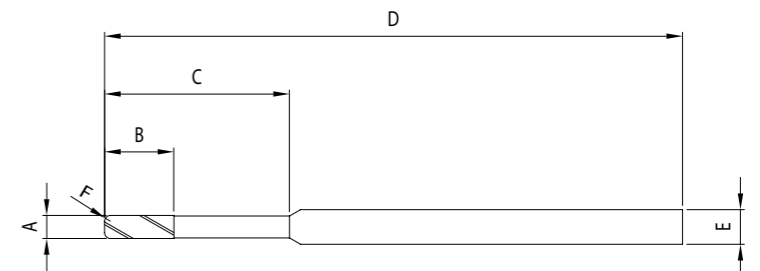

1  
2



3  
4 www.iditools.com



**customer example:**  
 Tool: DMB1-2-3-16-50 1mm ball nose end mill  
 Process: finishing  
 Spindle speed: 25000 rpm  
 Feedrate: 500mm/min.  
 Material: Zirconia  
 Tool life: 500 crowns

**Beispiel:**  
 Fräser: DMB1-2-3-16-50 1mm, mit Kugelkopf  
 Prozess: Endbearbeitung  
 Spindelgeschwindigkeit: 25.000 U/Min  
 Vorschub: 500 mm/min  
 Material: Zirkon  
 Lebensdauer: 500 Einheiten

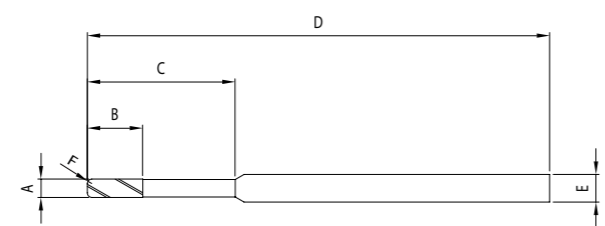

**Tools for Zirconia (Metric)**  
**Fräser für Zirkon ( Metrisch )**

unit: mm

Tool Type	Part No.	Cutting Diameter A	No. of Flutes	Flute Length B	Effective Length C	Overall Length D	Shank Diameter E	Corner Radius F
Square End Quadratisch	DMS02-2-0.3-0.3-40	0.2	2	0.3	0.3	40	3	
	DMS03-2-0.45-0.45-40	0.3	2	0.45	0.45	40	3	
	DMS04-2-0.6-0.6-40	0.4	2	0.6	0.6	40	3	
	DMS05-2-1.5-1.5-40	0.5	2	1.5	1.5	40	3	
	DMS05-2-1.5-4-40	0.5	2	1.5	4	40	3	
	DMS06-2-1.8-1.8-40	0.6	2	1.8	1.8	40	3	
	DMS06-2-1.8-5-40	0.6	2	1.8	5	40	3	
	DMS08-2-2.4-2.4-40	0.8	2	2.4	2.4	40	3	
	DMS08-2-2.4-7-40	0.8	2	2.4	7	40	3	
	DMS1-2-3-3-50	1	2	3	3	50	3	
	DMS1-2-3-6-50	1	2	3	6	50	3	
	DMS1-2-3-10-50	1	2	3	10	50	3	
	DMS1-2-3-16-50	1	2	3	16	50	3	
	DMS1-2-3-20-50	1	2	3	20	50	3	
	DMS2-4-6-6-50	2	4	6	6	50	3	
	DMS2-4-6-10-50	2	4	6	10	50	3	
	DMS2-4-6-16-50	2	4	6	16	50	3	
	DMS2-4-6-20-50	2	4	6	20	50	3	
Ball Nose Kugelförmig	DMB02-2-0.2-0.2-40	0.2	2	0.2	0.2	40	3	
	DMB03-2-0.3-0.3-40	0.3	2	0.3	0.3	40	3	
	DMB04-2-0.4-0.4-40	0.4	2	0.4	0.4	40	3	
	DMB05-2-0.5-1.5-40	0.5	2	0.5	1.5	40	3	
	DMB05-2-0.5-4-40	0.5	2	0.5	4	40	3	
	DMB06-2-0.6-1.8-40	0.6	2	0.6	1.8	40	3	
	DMB06-2-0.6-5-40	0.6	2	0.6	5	40	3	
	DMB08-2-0.8-2.4-40	0.8	2	0.8	2.4	40	3	
	DMB08-2-0.8-7-40	0.8	2	0.8	7	40	3	
	DMB1-2-3-3-50	1	2	3	3	50	3	
	DMB1-2-3-6-50	1	2	3	6	50	3	
	DMB1-2-3-10-50	1	2	3	10	50	3	
	DMB1-2-3-14-42	1	2	3	14	42	3	★
	DMB1-2-3-16-50	1	2	3	16	50	3	
	DMB1-2-3-20-50	1	2	3	20	50	3	
	DMB2-4-6-6-50	2	4	6	6	50	3	
	DMB2-4-6-10-50	2	4	6	10	50	3	
	DMB2-4-6-16-50	2	4	6	16	50	3	
DMB2-4-6-20-50	2	4	6	20	50	3		
DMB2.5-2-7-20-42	2.5	2	7	20	42	3	★	
Corner Radius flach	DMC1-2-3-3-50	1	2	3	3	50	3	0.2
	DMC1-2-3-6-50	1	2	3	6	50	3	0.2
	DMC1-2-3-10-50	1	2	3	10	50	3	0.2
	DMC1-2-3-16-50	1	2	3	16	50	3	0.2
	DMC1-2-3-20-50	1	2	3	20	50	3	0.2
	DMC2-4-6-6-50 R0.2/0.5	2	4	6	6	50	3	0.2/0.5
	DMC2-4-6-10-50 R0.2/0.5	2	4	6	10	50	3	0.2/0.5
	DMC2-4-6-16-50 R0.2/0.5	2	4	6	16	50	3	0.2/0.5
DMC2-4-6-20-50 R0.2/0.5	2	4	6	20	50	3	0.2/0.5	

★ Special Specification

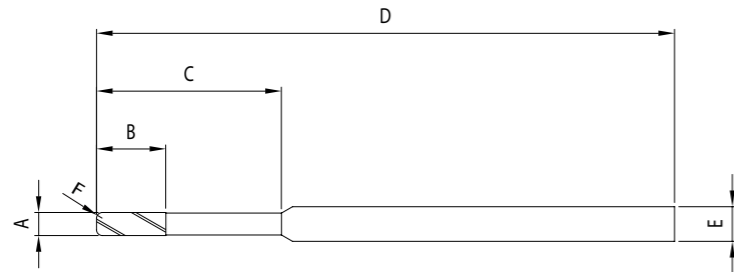

www.iditools.com

**Tools for Zirconia (Inch)**  
**Fräser für Zirkon ( Inch )**

unit: inch

Tool Type	Part No.	Cutting Diameter A	No. of Flutes	Flute Length B	Effective Length C	Overall Length D	Shank Diameter E	Corner Radius F
Square End Quadratisch	DES02-2-04-04-30	1/64	2	3/64	3/64	2	1/8	
	DES02-2-04-10-30	1/64	2	3/64	5/32	2	1/8	
	DES03-2-07-07-30	1/32	2	3/32	3/32	2	1/8	
	DES03-2-07-13-30	1/32	2	3/32	5/16	2	1/8	
	DES03-2-07-16-30	1/32	2	3/32	1/2	2	1/8	
	DES04-2-09-09-30	3/64	2	9/64	9/64	2	1/8	
	DES04-2-09-13-30	3/64	2	9/64	5/16	2	1/8	
	DES04-2-09-16-30	3/64	2	9/64	1/2	2	1/8	
	DES04-2-09-20-30	3/64	2	9/64	3/4	2	1/8	
	DES05-2-11-11-31	1/16	2	3/16	3/16	2 1/2	1/8	
	DES05-2-11-14-31	1/16	2	3/16	3/8	2 1/2	1/8	
	DES05-2-11-16-31	1/16	2	3/16	1/2	2 1/2	1/8	
	DES05-2-11-19-31	1/16	2	3/16	13/20	2 1/2	1/8	
	DES05-2-11-21-31	1/16	2	3/16	4/5	2 1/2	1/8	
	DES05-2-11-22-31	1/16	2	3/16	1	2 1/2	1/8	
	DES07-4-11-11-31	3/32	4	3/16	3/16	2 1/2	1/8	
DES07-4-11-14-31	3/32	4	3/16	3/8	2 1/2	1/8		
DES07-4-11-16-31	3/32	4	3/16	1/2	2 1/2	1/8		
DES07-4-11-22-31	3/32	4	3/16	1	2 1/2	1/8		
Ball Nose Kugelförmig	DEB02-2-04-04-30	1/64	2	3/64	3/64	2	1/8	
	DEB02-2-04-10-30	1/64	2	3/64	5/32	2	1/8	
	DEB03-2-07-07-30	1/32	2	3/32	3/32	2	1/8	
	DEB03-2-07-13-30	1/32	2	3/32	5/16	2	1/8	
	DEB03-2-07-16-30	1/32	2	3/32	1/2	2	1/8	
	DEB04-2-09-09-30	3/64	2	9/64	9/64	2	1/8	
	DEB04-2-09-13-30	3/64	2	9/64	5/16	2	1/8	
	DEB04-2-09-16-30	3/64	2	9/64	1/2	2	1/8	
	DEB04-2-09-20-30	3/64	2	9/64	3/4	2	1/8	
	DEB05-2-11-11-31	1/16	2	3/16	3/16	2 1/2	1/8	
	DEB05-2-11-14-31	1/16	2	3/16	3/8	2 1/2	1/8	
	DEB05-2-11-16-31	1/16	2	3/16	1/2	2 1/2	1/8	
	DEB05-2-11-19-31	1/16	2	3/16	13/20	2 1/2	1/8	
	DEB05-2-11-21-31	1/16	2	3/16	4/5	2 1/2	1/8	
	DEB05-2-11-22-31	1/16	2	3/16	1	2 1/2	1/8	
	DEB07-4-11-11-31	3/32	4	3/16	3/16	2 1/2	1/8	
DEB07-4-11-14-31	3/32	4	3/16	3/8	2 1/2	1/8		
DEB07-4-11-16-31	3/32	4	3/16	1/2	2 1/2	1/8		
DEB07-4-11-22-31	3/32	4	3/16	1	2 1/2	1/8		
Corner Radius flach	DEC05-2-11-11-31	1/16	2	3/16	3/16	2 1/2	1/8	0.01
	DEC05-2-11-14-31	1/16	2	3/16	3/8	2 1/2	1/8	0.01
	DEC05-2-11-16-31	1/16	2	3/16	1/2	2 1/2	1/8	0.01
	DEC05-2-11-19-31	1/16	2	3/16	13/20	2 1/2	1/8	0.01
	DEC05-2-11-21-31	1/16	2	3/16	4/5	2 1/2	1/8	0.01
	DEC05-2-11-22-31	1/16	2	3/16	1	2 1/2	1/8	0.01
	DEC07-4-11-11-31	3/32	4	3/16	3/16	2 1/2	1/8	0.01
	DEC07-4-11-14-31	3/32	4	3/16	3/8	2 1/2	1/8	0.01
DEC07-4-11-16-31	3/32	4	3/16	1/2	2 1/2	1/8	0.01	
DEC07-4-11-22-31	3/32	4	3/16	1	2 1/2	1/8	0.01	



**IDI Precision Machinery Ltd.**

No.138 Ln.477 Sec.2 Chung Shan Rd.,  
Taiping, Taichung, 411  
Taiwan

TEL: +886-4-23937395

FAX: +886-4-23934460

Website: [www.iditools.com](http://www.iditools.com)